



**File Name:** canon fax machine l295 manual.pdf

**Size:** 4323 KB

**Type:** PDF, ePub, eBook

**Category:** Book

**Uploaded:** 29 May 2019, 20:48 PM

**Rating:** 4.6/5 from 696 votes.

**Status:** AVAILABLE

Last checked: 3 Minutes ago!

**In order to read or download canon fax machine l295 manual ebook, you need to create a FREE account.**

[\*\*Download Now!\*\*](#)

eBook includes PDF, ePub and Kindle version

[Register a free 1 month Trial Account.](#)

[Download as many books as you like \(Personal use\)](#)

[Cancel the membership at any time if not satisfied.](#)

[Join Over 80000 Happy Readers](#)

### Book Descriptions:

We have made it easy for you to find a PDF Ebooks without any digging. And by having access to our ebooks online or by storing it on your computer, you have convenient answers with canon fax machine l295 manual . To get started finding canon fax machine l295 manual , you are right to find our website which has a comprehensive collection of manuals listed.

Our library is the biggest of these that have literally hundreds of thousands of different products represented.



## Book Descriptions:

# canon fax machine l295 manual



All drivers were scanned with antivirus program for your safety. Try upgrading the device drivers for this device. Code 10 The driver may be corrupted or missing. Code 39 This can be easily fixed by using driver update tool or by updating drivers manually. Download appropriate driver for Canon FAXL295 for your operating system from our website. Page 3 Super G3 is a phrase used to describe the new generation of. Chapter 1 IntroductionPage 7 Chapter 10 Copying. Chapter. Page 8 Chapter 14 Summary of SettingsPage 11 In addition, this guide uses distinctive typefaces to identify buttons and informationKeep the area free soPage 18 Assembling the FAXPage 19 Making Connections. Connecting the Telephone Line Cord and External. DevicesPage 23 6 Press OK.Page 26 Installing the Toner CartridgePage 27 Follow this procedure to install the toner cartridge in the FAXPage 28 5 Place and support the toner cartridge onPage 31 Chapter 3Page 35 Registering Sender Information. What is Sender InformationPage 36 Entering the Date and TimePage 39 Dialling Through a Switchboard. If your FAXPage 49 Chapter 5Page 50 Paper RequirementsDeliveryIf you want to load a. Page 55 10 Use or to select the custom paper sizePage 58 What is Speed DiallingPage 63 Registering Coded Speed DiallingPage 64 8 Press OK twice.Page 67 Registering Group DiallingPage 71 Making a Telephone Call With Speed Dialling. Page 72 Dialling with the DirectoryPage 78 Preparing to Send a Fax. Documents You Can FaxPage 79 Setting the Scanning ContrastPage 80 Dialling MethodsThey are asPage 88 Sending the Same Document to Several Fax. Numbers Sequential BroadcastingPage 89 Regular diallingPage 93 Deleting a Document Set for Delayed SendingTo determine whichPage 97 If FAX ONLY MODE does not appear in the LCD when you press Receive Mode,Page 98 Receiving Both Faxes and Telephone CallsPage 104 Receiving While Performing Other TasksPage 105 Cancelling ReceivingPage 108 Special Dialling.<http://apletechsolutions.com/userfiles/download-mississippi-driver-s-manual.xml>

- **canon fax machine l295 manual, canon fax machine l295 manual download, canon fax machine l295 manual pdf, canon fax machine l295 manual free, canon fax machine l295 manual instructions.**

## 3.2 IMAGE FORMATION SYSTEM

### 3.2.1 Transfer Charging Roller

#### 3.2.1.1 Removing the External cover

0003-4088

- 1) Open the front cover using the release tab [1] and then remove 2 screws [2] and 4 screws [3].
- 2) Remove the connector cover [4].
- 3) Remove the external cover [5].
- 4) Remove the multi-purpose tray unit [6].

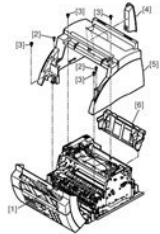

F-3-29

#### 3.2.1.2 Removing the Reading ass'y

0003-4099

- 1) Remove the connector [1] connected to the SCNT board.
- 2) Remove the screw [2] and the earth wire.
- 3) Remove the pin [3].
- 4) Remove the Reading ass'y [4].

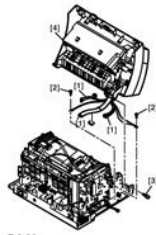

F-3-30

#### 3.2.1.3 Removing the Transfer charging roller

0003-4103

- 1) Use a precision screwdriver or similar to remove the transfer guide [1].
- 2) Remove the Transfer charging roller [2]. Be careful not to touch the sponge section.

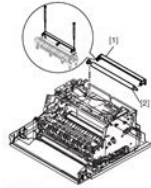

F-3-31

Page 109 Switching Temporarily to Tone Dialling  
 Page 110 Documents Stored in Memory  
 What is Polling  
 Polling. Page 118 5 Press OK three times.  
 Page 121 2 Press Data Registration.  
 Page 123 10 Press Stop to return to standby mode. Ex  
 Page 125 Restricting Reception  
 Page 126 11 Press OK.  
 Page 133 ACTIVITY REPORT  
 Page 138 Periodic Cleaning  
 Please note  
 Page 139 Cleaning the FAX's Interior  
 Page 140 5 When you are finished, reinsert the  
 Page 144 8 Hold the toner cartridge by its handle  
 Jams in the ADF  
 Page 147 Paper Jams  
 Try clearing the  
 Page 149 4 Locate the paper jam and clear it as  
 Page 151 5 When you finished, reinsert the toner  
 Page 152 LCD Messages  
 CHECK COVER — The front cover is open. Close the front cover. CHECK DOCUMENT. Page 154 Message Error Code Cause Action. Page 155 Message Error Code Cause Action  
 MEMORY USED nn % — Shows the percentage of If you need more space. Page 156 Message Error Code Cause Action. Page 157 Paper Feeding Problems  
 Page 160 An error may have occurred during reception.  
 Page 163 You may not have removed the plastic seal from the toner cartridge. Page 164 General Problems  
 Page 166 If a Power Cut Occurs. Page 167 Chapter 14  
 Page 168 Understanding the Menu System  
 The selectable settings and the default settings. Page 171 REPORT SETTINGS Menu. The selectable settings and the default settings. Page 172 TX Transmission SETTINGS Menu. The selectable settings and the default. Page 173 RX Reception SETTINGS Menu. The selectable settings and the default. Page 174 PRINTER SETTINGS Menu. The selectable settings and the default settings. Page 175 POLLING BOX Menu. The selectable settings and the default settings. Page 176 SYSTEM SETTINGS Menu. The selectable settings and the default settings. RX START SPEED Selects the speed at which the FAX starts receiving. 33600bps  
 Page 184 Introduction  
 Page 185 Connecting the FAXL295 to Your PC  
 Page 186 Print Media Requirements  
 Page 193 Attaching the Handset to Your FAX  
 Page 194 Maintaining Your Handset  
 Page 198 Messages.  
<http://egicosolutions.com/userfiles/download-modern-physics-serway-solution-manual.xml>

## 4.5 Lubrications

### 4.5.1 Areas Requiring Application of Grease

0003-1683

The machine has areas that require grease to permit smooth movement of parts or ensure good electrical conductivity. If you have replaced a part in these areas or if you have removed the grease, be sure to apply grease.

#### Upper ADF

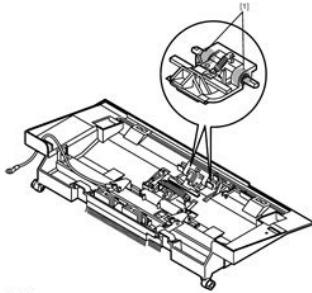

F-4-3

[1] MOLYKOTE EM-50L, Approx. 5 to 25 mg

#### Lower ADF

4-8

See LCD messages Paper delivery. We delete comments that violate our policy, which we encourage you to read. Discussion threads can be closed at any time at our discretion. We hope that this CANON FAXL295 user guide will be useful to you. FAXL220 Fax Machine pdf manual download. Ghidul utilizatorului. Users Guide. Canon mechanical, magnetic, optical, chemical, manual, or otherwise, without the prior written permission of Canon, Inc. FAXL200 what does a stool sample test for, free camera owners manual Ciara dance instruction video, To kill a mockingbird study guide answers, Maple story making mesos guide, Used semi truck price guide, Complete anglers guide to oregon. Post your question here in this forum. Were committed to dealing with such abuse according to the laws in your country of residence. When you submit a report, well investigate it and take the appropriate action. Well get back to you only if we require additional details or have more information to share. Note that email addresses and full names are not considered private information. Please mention this; Therefore, avoid filling in personal details. Please enter your email address. I am not sure how you plug phone and fax lines. Please help. Avtar Hi THE main difference in the phone fax line is that if you are only using as a fax plug the cable from phone I have check line other side no using. I cant send or receive any fax. Plug a regular phone into. Press funktion, data registration, scroll down until you get report settings, press ok and scroll down to It sends fax but does not receive. That is, it does not print.



<http://superbia.lgbt/flotaganis/1648506416>

<https://inclinedbedtherapy.com/images/bt3-manual-pdf.pdf>



<http://impressionmexico.com/images/btgps74r-user-manual.pdf>



<http://chicagohalo.com/wp-content/plugins/formcraft/file-upload/server/content/files/1627189ad573c7---brand-new-manual-treadmill.pdf>

<http://gbb.global/blog/bosch-integra-dishwasher-owner-s-manual>